

CHATHAM COUNTY PURCHASING DEPARTMENT

ADDENDUM NO. 1 FOR BID NO. 10-2-18-3

SPORTS LIGHTING AT L. SCOTT STELL PARK FOR PUBLIC WORKS AND PARK SERVICES

PLEASE NOTE: Proposal remain due : 2:00 p.m., 22 October 2009.

Please make the following changes to the solicitation:

Pg. 15, Paragraph 3.7 BONDS ** NO BONDS REQUIRED**

Correction:

BONDS ** REQUIRED**

- B. Contractor(s) shall post a payment/performance bond, bank certified check or postal money order made payable to the Chatham County Board of Commissioners in the amount of 100% of the bid price if awarded. Such bond(s) are due prior to contract execution as a guarantee that goods meet specifications and will be delivered as per contract. Such bonds will also guarantee quality performance of services and timely payment of invoices to any subcontractors.
- C. Whenever a bond is provided, it shall be executed by a surety authorized to do business in the State of Georgia and approved by Chatham County.

Pg. 16, Paragraph 3.10 Warranty Requirements: *NOT APPLICABLE TO THIS SOLICITATION*****

Correction:

Warranty Requirements: * APPLICABLE TO THIS SOLICITATION *****

- B. Warranty required.
 - 1. Standard warranty shall be offered with bid.
 - 2. Extended warranty shall be offered with bid The cost of the extended warranty will be listed separately on the bid sheet.

PLEASE NOTE: THE INSTALLATION COMPANY MUST HAVE THE SYSTEM AND OR LIGHTING TESTED AND OR CALIBRATED.

**CHATHAM COUNTY, GEORGIA
SURETY REQUIREMENTS**

A Bid Bond for five percent (5%) of the amount of the bid is not required to be submitted with each bid.

A Performance Bond for one hundred percent (100%) of the bid will be required of the successful bidder.

The Bidder certifies that he/she has examined all documents contained in this bid package, and is familiar with all aspects of the proposal and understands fully all that is required of the successful bidder. The Bidder further certifies that his/her bid shall not be withdrawn for thirty (30) days from the date on which his bid is publicly opened and read.

The Bidder agrees, if awarded this bid, he/she will:

- A. Furnish, upon receipt of an authorized Chatham County Purchase Order, all items indicated thereon as specified in this bid proposal for the bid amount, or;
- B. Enter a contract with Chatham County to do and/or furnish everything necessary to provide the service and/or accomplish the work as stated and/or specified in this bid proposal for the bid amount, and;
- C. Furnish, if required, a Performance Bond, and acknowledges Chatham County's right to require a Performance Bond of a specific kind and origin, and;
- D. Forfeit the amount of the Bid Bond if he/she fails to enter a contract with Chatham County as stated in (B) above, within fifteen (15) days of the date on which he/she is awarded the bid, and/or;
- E. Forfeit the amount of the Performance Bond if he/she fails to execute and fulfill the terms of the contract entered. The amount of forfeiture shall be:
 - 1. The difference between his/her bid and the next lowest, responsible bid that has not expired or been withdrawn, or;
 - 2. The difference between his/her bid and the amount of the lowest, responsible bid received as a result of rebidding, including all costs related to rebidding.

COMPANY

DATE

SIGNATURE

TITLE

TELEPHONE NUMBER

Attachments:

1. Drawings of Field # 2 and #4

**THE BIDDER IS RESPONSIBLE FOR MAKING THE NECESSARY CHANGES AND
MUST ACKNOWLEDGE RECEIPT OF ADDENDUM**

10/13/09
DATE:

William R. Parson
WILLIAM R. PARSON, CPPO,
PURCHASING AGENT
CHATHAM COUNTY, GEORGIA



MUSCO
GREEN GENERATION LIGHTING™

ILLUMINATION SUMMARY

Field 2
L Scott Stell Park
Savannah, GA

- Luminaire Type: Green Generation
- Rated Lamp Life: 5,000 hours
- Avg Lumens/Lamp: 134,000

Field 2
• Size: 300'/325'/300' - 90' Basepath
• Grid Spacing = 30.0' x 30.0'
• Values given at 3.0' above grade

CONSTANT ILLUMINATION HORIZONTAL FOOTCANDLES

	Infield	Outfield
No. of Target Points:	25	82
Average:	50.5	30.5
Maximum:	66	45
Minimum:	35	20
Avg/Min:	1.43	1.54
Max/Min:	1.88	2.28
UG (Adjacent Pts):	1.39	1.62
CV:	0.16	0.18
Average Lamp Tilt Factor:		1.000
Number of Luminaires:		36
Avg KW over 5,000 hours:		56.3
Max KW:		61.2

Guaranteed Performance: The CONSTANT ILLUMINATION described above is guaranteed for the rated life of the lamp.

Field Measurements: Averages shall be +/-10% in accordance with IESNA RP-6-01 and CIBSE LG4. Individual measurements may vary from computer predictions.

Electrical System Requirements: Refer to Amperage Draw Chart and/or the "Musco Control System Summary" for electrical sizing.

Installation Requirements: Results assume +/-3% nominal voltage at line side of the ballast and structures located within 3 feet (1m) of design locations.

By: Matt Sullivan
File #: 129944BR/4 Date: 31-Jul-09

Not to be reproduced in whole or part without the written consent of Musco Lighting. ©1981, 2009 Musco Lighting

EQUIPMENT LIST FOR AREAS SHOWN								
Pole			Luminaires					
QTY	LOCATION	SIZE	GRADE ELEVATION	MOUNTING HEIGHT	LAMP TYPE	QTY / POLE	THIS GRID	OTHER GRIDS
1	A1	70'	-	70'	1000W/MZ	1	0	1
1	A2	70'	-	70'	1500W/MZ	5/5*	5	5
1	B1	80'	-	80'	1500W/MZ	8/7*	8	7
1	B2	80'	-	80'	1000W/MZ	1	0	1
1	C1-C2	70'	-	70'	1500W/MZ	8/7*	8	7
2	C1-C2	70'	-	70'	1500W/MZ	5	5	0
6	TOTALS					62	36	26

* This structure utilizes a back-to-back mounting configuration

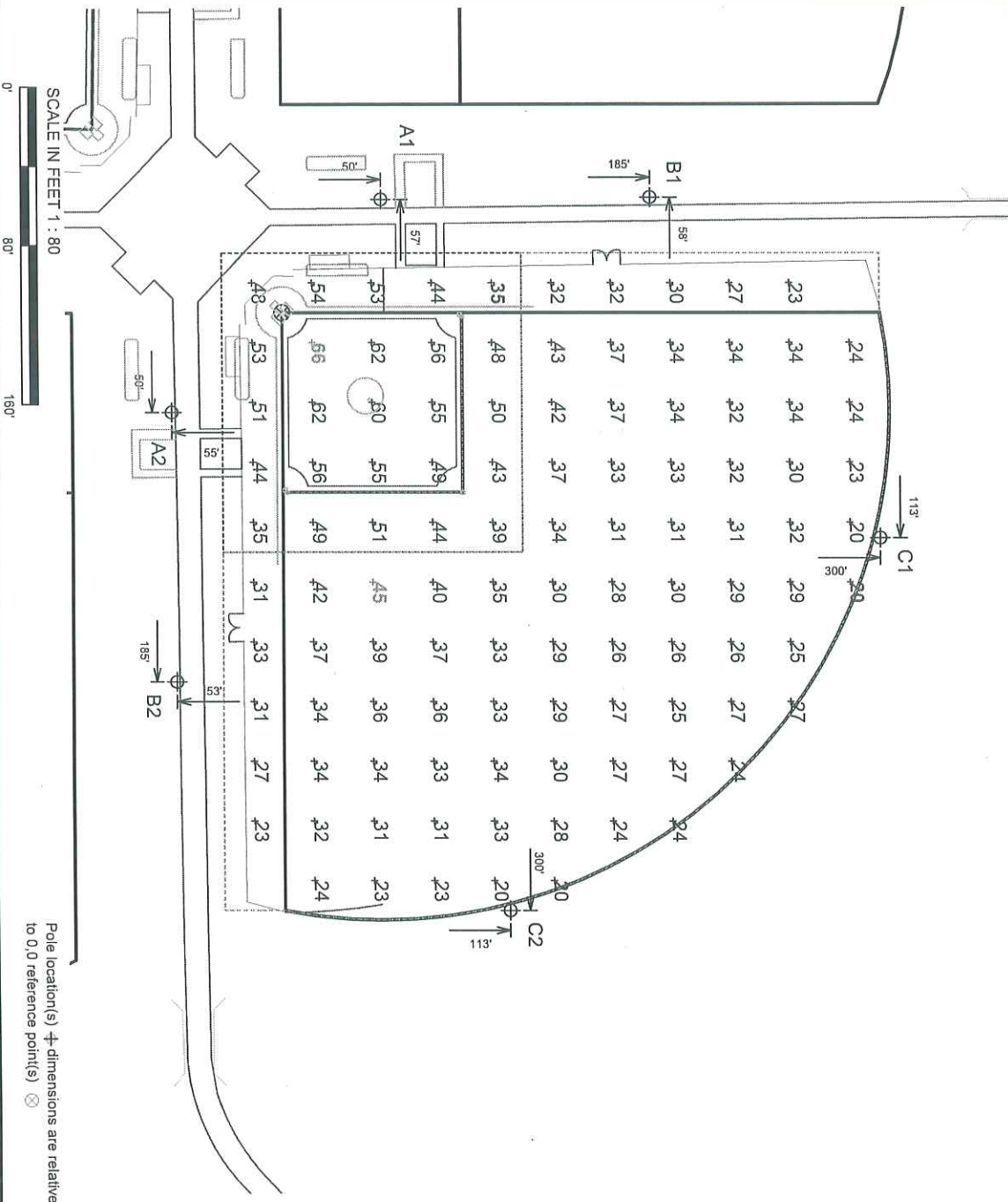

Pole location(s) + dimensions are relative to 0.0' reference point(s) ⊗



GUARANTEED PERFORMANCE

ILLUMINATION SUMMARY

Field 4
L Scott Stell Park
Savannah, GA

- Size: 300'/350'/300' - 90' Basepath
- Grid Spacing = 30.0' x 30.0'
- Values given at 3.0' above grade

- Luminaire Type: Green Generation
- Rated Lamp Life: 5,000 hours
- Avg Lumens/Lamp: 134,000

**CONSTANT ILLUMINATION
HORIZONTAL FOOTCANDLES**

	Infield	Outfield
No. of Target Points:	25	90
Average:	50.8	31.6
Maximum:	66	49
Minimum:	37	21
Avg/Min:	1.37	1.54
Max/Min:	1.80	2.38
UG (Adjacent Pts):	1.45	1.49
CV:	0.16	0.16

Average Lamp Tilt Factor: 1.000
 Number of Luminaires: 40
 Avg KW over 5,000 hours: 62.56
 Max KW: 68.0

Guaranteed Performance: The CONSTANT ILLUMINATION described above is guaranteed for the rated life of the lamp.

Field Measurements: Averages shall be +/-10% in accordance with IESNA RP-6-01 and CIBSE LG4. Individual measurements may vary from computer predictions.

Electrical System Requirements: Refer to Amperage Draw Chart and/or the "Musco Control System Summary" for electrical sizing.

Installation Requirements: Results assume +/-3% nominal voltage at line side of the ballast and structures located within 3 feet (1m) of design locations.

By: Matt Sullivan

File #: 129944BR/4

Date: 31-Jul-09

Not to be reproduced in whole or part without the written consent of Musco Lighting. ©1981, 2009 Musco Lighting

Print Date (31/Jul/2009) & Time (10:02)

EQUIPMENT LIST FOR AREAS SHOWN								
Pole			Luminaires					
QTY	LOCATION	SIZE	GRADE ELEVATION	MOUNTING HEIGHT	LAMP TYPE	QTY / POLE GRID	THIS GRID	OTHER GRIDS
1	A3	70'	-	70'	1500W MZ	5/5*	5	5
1	A4	70'	-	70'	1000W MZ	5/5*	0	1
1	B3	80'	-	80'	1500W MZ	7/8*	8	7
1	B4	80'	-	80'	1000W MZ	1	0	1
1	C5-C6	70'	-	70'	1500W MZ	8/7*	8	7
6	TOTALS				1500W MZ		66	40

* This structure utilizes a back-to-back mounting configuration

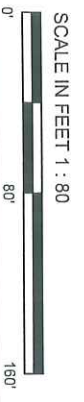
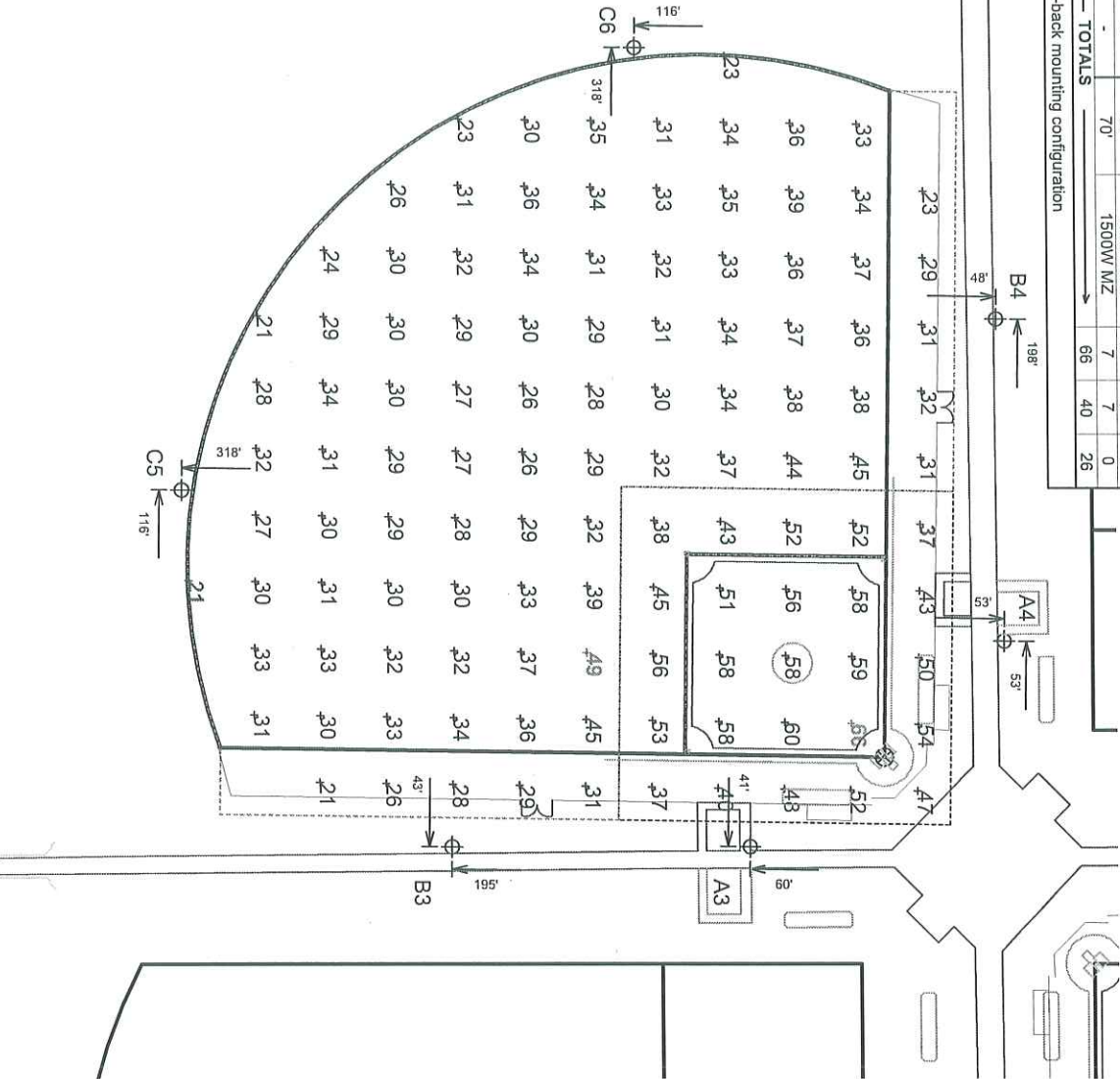

SCALE IN FEET 1 : 80

Pole location(s) + dimensions are relative to 0.0 reference point(s) ⊗