

FOR: RELANDSCAPING AT THE JUDICIAL COURTHOUSE

PLEASE SEE THE FOLLOWING ADDITIONS, CLARIFICATIONS AND/OR CHANGES:

1. **Question:** Could we get a new detail on the brick installation in the path ways. The new paver that has been specified is a thicker paver than the original and there are several different ways that this can be installed.

Response: *2 1/4" Height, 4" Width, 8" Long*

2. **Question:** Is the "old mill" brick paver to be:
Set inside the concrete with or without grout lines?
Mortared in with or without grout lines?
Dry set with no grout lines?

Response: *Mortared in with grout lines.*

3. **Question:** Can I also get a definite dimension of the pavers that are shaped in an octagon pattern and the exterior pattern as the lengths of the lines are not symmetrical on the Martin Luther King Jr Blvd side of the building and I would assume they would want to be. A lineal footage for the total length would also be of great help. A new detail/ more accurate drawing of this would be of great help.

Response: *Same Pavers.*

4. **Question:** With the Tabby concrete, what size oyster shell is to be specified for installation of the concrete? To my knowledge, #3 is the most common used, but I just wanted to make sure.

Response: *#2*

5. **Question:** Can we get an updated plant list?

Response: *See attached plant list*

6. **Question:** On the plans dated 12/17/2010, on all three walkways, there are lines drawn across the paths from swales. Are these drain lines:

To be installed under the ground?

Are they u channel drains concreted into the path?

Is the path to be elevated with the pipe at ground level?

Or are they sleeves? If they are sleeves, what is their purpose? It does not show the electrical

lines passing through them and the irrigation is a design build.

Response: *Refer to original plans*

7. Question: There is no markings on this plan as to what these are. These lines look exactly like the drain line that is be connected to the storm sewer, but they are not connected to anything.

Response: *Refer to original plans*

8. Question: The colors for the benches, trash receptacles etc, have been assigned two possible colors, matte black or hunter green. Who will be making the decision on the colors of the benches?

Response: *The color is matte black.*

9. Question: On the drawing modified on 12/09/2010, it looks like the dark pen marks are the electrical design. Is this the case? Also there is a new type of rectangles and squares. Are these benches, lights and trash receptacles?

Response: *Drawing on 12/19/10 shows squares. Drawing of 12/17/10 show circles for trash receptacles.*

THE BID DUE DATE REMAINS TO 2 PM, TUESDAY, 11 JANUARY 2011.

THE BIDDER IS RESPONSIBLE FOR MAKING THE NECESSARY CHANGES AND MUST ACKNOWLEDGE RECEIPT OF ADDENDUM.

01-05-07

DATE

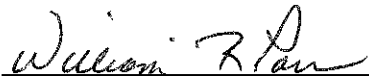

WILLIAM PARSON, CPPO
PURCHASING AGENT

JENKINS BRICK AND TILE COMPANY

Showroom (912) 963-1123

Fax (912) 963-0667

NOTE
↑
WHITE

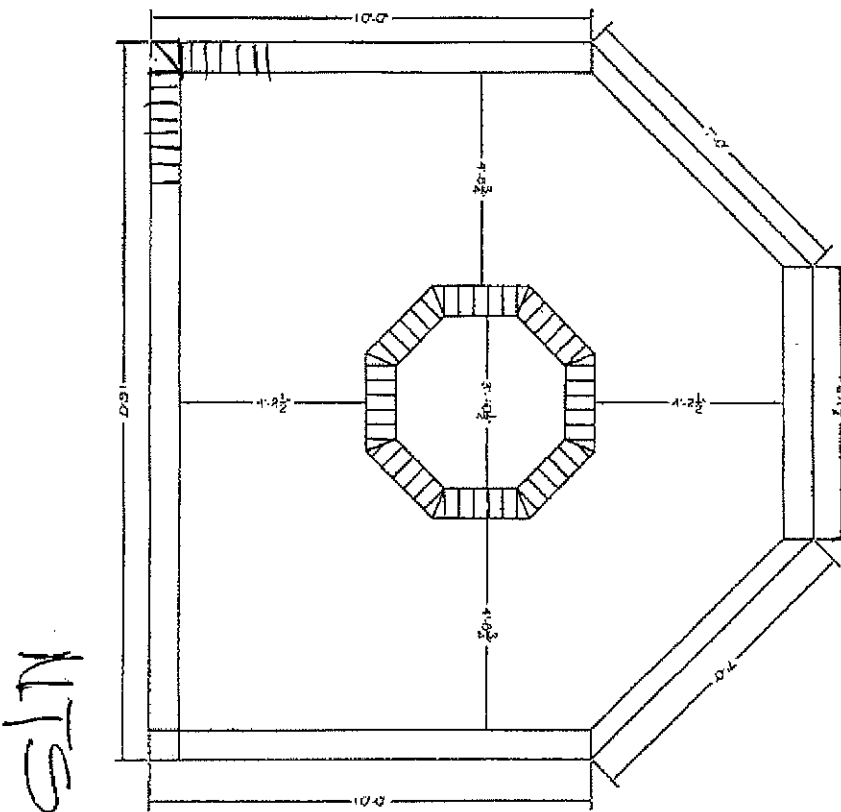

CHATHAM COUNTY COURTHOUSE

drawn by: stephanie lathan

CHATHAM COUNTY COURTHOUSE - PLANT SCHEDULE**TREES**

COUNT	BOTANICAL NAME	COMMON NAME	SIZES/REMARKS
5	LAGERSTROEMIA INDICA	CRAPE MYRTLE "NATCHEZ"	8'-10'; 3-STEMS
5	LAGERSTROEMIA INDICA	CRAPE MYRTLE "POTOMAC"	7'-8'

SHRUBS

9	MAHONIA BEALEII	LEATHERLEAF MAHONIA	24"-30" FULL 3 STEM MIN.
10	OSMANTHUS FRAGRANS	TEA OLIVE	30"-36" FULL
56	RAPHIOLEPSIS INDICA NANA	DWARF INDIAN HAWTHORNE	12"-15" FULL; 3'-4' O.C.
7	VIBURNUM SUSPENSUM	SANDANKWA VIBURNUM	24"-30" FULL; 5'-6' O.C.

GROUND COVERS

76	AGAPANTHUS AFRICANUS	AGAPANTHUS LILY	FULL GAL.; 12"-15" O.C.
63	MORAEA IRIDIOIDES	AFRICAN IRIS	FULL GAL; 3'-4' O.C.