

- 100 GENERAL
- 101 CONTRACTOR SHALL BE RESPONSIBLE FOR THE PROTECTION OF EXISTING UTILITIES AND STRUCTURES TO REMAIN. ANY DAMAGE TO EXISTING UTILITIES OR STRUCTURES SHALL BE REPAIRED AT THE CONTRACTOR'S EXPENSE. THE CONTRACTOR SHALL BE RESPONSIBLE FOR THE PROTECTION OF EXISTING UTILITIES AND STRUCTURES TO REMAIN. ANY DAMAGE TO EXISTING UTILITIES OR STRUCTURES SHALL BE REPAIRED AT THE CONTRACTOR'S EXPENSE.
 - 102 CONTRACTOR SHALL BE RESPONSIBLE FOR THE PROTECTION OF EXISTING UTILITIES AND STRUCTURES TO REMAIN. ANY DAMAGE TO EXISTING UTILITIES OR STRUCTURES SHALL BE REPAIRED AT THE CONTRACTOR'S EXPENSE.
 - 103 CONTRACTOR SHALL BE RESPONSIBLE FOR THE PROTECTION OF EXISTING UTILITIES AND STRUCTURES TO REMAIN. ANY DAMAGE TO EXISTING UTILITIES OR STRUCTURES SHALL BE REPAIRED AT THE CONTRACTOR'S EXPENSE.
 - 104 CONTRACTOR SHALL BE RESPONSIBLE FOR THE PROTECTION OF EXISTING UTILITIES AND STRUCTURES TO REMAIN. ANY DAMAGE TO EXISTING UTILITIES OR STRUCTURES SHALL BE REPAIRED AT THE CONTRACTOR'S EXPENSE.
 - 105 CONTRACTOR SHALL BE RESPONSIBLE FOR THE PROTECTION OF EXISTING UTILITIES AND STRUCTURES TO REMAIN. ANY DAMAGE TO EXISTING UTILITIES OR STRUCTURES SHALL BE REPAIRED AT THE CONTRACTOR'S EXPENSE.
 - 106 CONTRACTOR SHALL BE RESPONSIBLE FOR THE PROTECTION OF EXISTING UTILITIES AND STRUCTURES TO REMAIN. ANY DAMAGE TO EXISTING UTILITIES OR STRUCTURES SHALL BE REPAIRED AT THE CONTRACTOR'S EXPENSE.
 - 107 CONTRACTOR SHALL BE RESPONSIBLE FOR THE PROTECTION OF EXISTING UTILITIES AND STRUCTURES TO REMAIN. ANY DAMAGE TO EXISTING UTILITIES OR STRUCTURES SHALL BE REPAIRED AT THE CONTRACTOR'S EXPENSE.
 - 108 CONTRACTOR SHALL BE RESPONSIBLE FOR THE PROTECTION OF EXISTING UTILITIES AND STRUCTURES TO REMAIN. ANY DAMAGE TO EXISTING UTILITIES OR STRUCTURES SHALL BE REPAIRED AT THE CONTRACTOR'S EXPENSE.
 - 109 CONTRACTOR SHALL BE RESPONSIBLE FOR THE PROTECTION OF EXISTING UTILITIES AND STRUCTURES TO REMAIN. ANY DAMAGE TO EXISTING UTILITIES OR STRUCTURES SHALL BE REPAIRED AT THE CONTRACTOR'S EXPENSE.
 - 110 CONTRACTOR SHALL BE RESPONSIBLE FOR THE PROTECTION OF EXISTING UTILITIES AND STRUCTURES TO REMAIN. ANY DAMAGE TO EXISTING UTILITIES OR STRUCTURES SHALL BE REPAIRED AT THE CONTRACTOR'S EXPENSE.

- 200 TIMBER CONSTRUCTION
- 201 ALL TIMBER SHALL BE EQUIPMENT FINE, TYPICAL DIMENSIONS TO BE AS SHOWN, UNLESS OTHERWISE SPECIFIED. ALL TIMBER SHALL BE DRY KILN DRIED TO A MAXIMUM MOISTURE CONTENT OF 19% AT THE TIME OF DELIVERY TO THE PROJECT SITE. ALL TIMBER SHALL BE STORED PROTECTED FROM WEATHER AND SHALL BE KEPT COVERED UNTIL READY FOR INSTALLATION. ALL TIMBER SHALL BE STORED ON A DRY, LEVEL SURFACE. ALL TIMBER SHALL BE STORED AT LEAST 20 FEET FROM EXISTING UTILITIES AND STRUCTURES TO REMAIN. ALL TIMBER SHALL BE STORED AT LEAST 20 FEET FROM EXISTING UTILITIES AND STRUCTURES TO REMAIN.
 - 202 ALL LUMBER AND TIMBER SHALL BE TREATED IN ACCORDANCE WITH ANPA C2 AS LISTED IN ANPA TO A RETENTION LEVEL AS SHOWN.
 - 203 CROSS BRACING, STIFFENERS, POSTS, AND BRACES SHALL BE INSTALLED IN ACCORDANCE WITH ANPA C2 AS LISTED IN ANPA TO A RETENTION LEVEL AS SHOWN.
 - 204 ALL PLATE WALKERS SHALL CONFORM WITH ASTM A36.
 - 205 ALL BOLT NUTS SHALL CONFORM WITH ASTM A307. BOLT NUTS SHALL CONFORM WITH ASTM A307.
 - 206 ALL WELDS SHALL CONFORM WITH ASTM A572.
 - 207 UNLESS NOTED OTHERWISE, USE ONE (1) FULL LENGTH MEMBER.
 - 208 COUNTERBORE HOLES FROM BOLTS FOR DOWNER SPOONS BOLT NUTS AND WASHERS.
 - 209 WHERE PRACTICAL, CUT TIMBER TO BE JOINED LENGTH WITH STEEL CUTS AND NO WASTAGE. TIMBER CUTS AND NOTES IN THE FIELD.
 - 210 PRIOR TO ERECTION OF TIMBERS, CUT ALL CUT, BEVEL, SHIMED AND DAMAGED MEMBER AS SHOWN ACCORDANCE WITH ANPA C2.
 - 211 ERECT TIMBER WORK PLUMB AND LEVEL WITH TIGHT JOINTS BETWEEN ALL MEMBERS.
 - 212 TIGHTEN BOLTS SUFFICIENTLY TO BRING ALL BOLTING WASHERS INTO CONTACT.
 - 213 CUT END GRAIN OF ALL EXPOSED VERTICAL TIMBERS WITH PRESERVATIVE.
 - 214 EXPOSED CORNER MEMBERS, TIMBER TO AVOID SPLITTING AND STRUCTURAL DAMAGE DURING UNLOADING OPERATIONS, OR WHILE PALLET FOR HANDRAIL TIMBER.
 - 215 STAKE TIMBER UNDER CORNER ABOVE GROUND AND KEEP FREE FROM DIST. BRASS OR BRASS STUDS SHALL BE INSTALLED IN ALL CORNERS THAT WILL PREVENT LONG TIMBERS FROM SLIDING OR ROTATING.

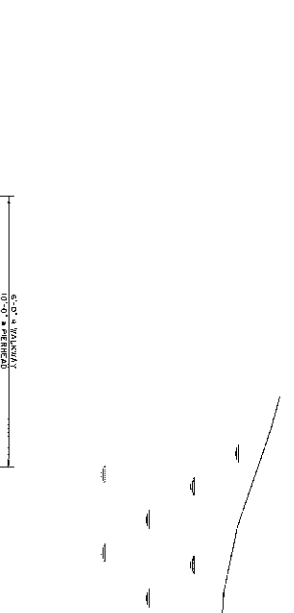

2 DEMOLITION DETAIL
SCALE: 5/8" = 1'-0"

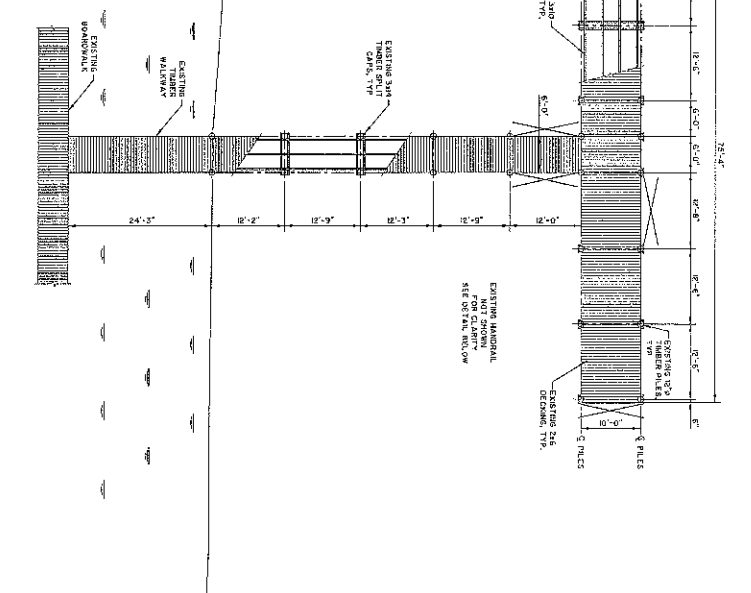

1 EXISTING PIER LAYOUT
SCALE: 1" = 10'-0"

3 EXISTING HANDRAIL DETAIL
SCALE: 5/8" = 1'-0"

 CHATHAM COUNTY PUBLIC WORKS CHATHAM COUNTY, GEORGIA FRANK SPENCER FISHING PIER REPAIRS GENERAL NOTES, EXISTING LAYOUT & DEMOLITION	THOMAS & HUTTON Engineers & Architects 50 Park of Commerce Way • PO Box 2727 Savannah, GA 31402-2727 • 912.234.5500 www.thomasandhutton.com			
S0.1				